



OIML Member State
Slovakia

OIML Certificate No.
R76/2006-A-SK1-18.01

OIML CERTIFICATE ISSUED UNDER SCHEME A

OIML Issuing Authority

Name: Slovak Legal Metrology
Address: Hviezdoslavova 31
Person responsible: Jaromír Markovič, Director General

Applicant

Name: Shanghai Zhuojing Electronic Technology Co., Ltd.
Address: Building 26, No.99, Chunguang Road, Xinzhuang Ind. Zone,
Minhang, Shanghai, P. R. of China

Manufacturer

Name: Shanghai Zhuojing Electronic Technology Co., Ltd.
Address: Building 26, No.99, Chunguang Road, Xinzhuang Ind. Zone,
Minhang, Shanghai, P. R. of China

Identification of the certified type *(the detailed characteristics are defined in the additional pages)*

ACS-...E, ACS-...EP

Designation of the module *(if applicable)*

Non-automatic price-computing weighing instrument for direct sales to public

This OIML Certificate attests the conformity of the above identified type (represented by the sample(s) identified in the OIML type evaluation report) with the requirements of the following Recommendation of the International Organization of Legal Metrology (OIML):

OIML R 76, Edition: 2006

For accuracy class: III



OIML Certificate No.
R76/2006-A-SK1-18.01

This OIML Certificate relates only to metrological and technical characteristics of the type of measuring instrument covered by the relevant OIML Recommendation identified above.

This OIML Certificate does not bestow any form of legal international approval.

The conformity was established by the results of tests and examinations provided in the associated OIML type evaluation report:

No. 2015/NAWI/B/0003/001 dated 25.9.2018 that includes 24 pages

The technical documentation relating to the identified type is contained in documentation file:

No. 2015/NAWI/B/0003 dated 25.9.2018 that includes 66 pages

OIML Certificate History

Revision No.	Date	Description of the modification
Revision 0	28 September 2018	Certificate first issued.
-	-	-

Identification, signature and stamp

The OIML Issuing Authority

The OIML Member

.....
Jaromír Markovič

.....
Pavol Pavlis

Date: 28 September 2018

Date: 28 September 2018



Important note: Apart from the mention of the Certificate's reference number and the name of the OIML Member State in which the Certificate is issued, partial quotation of the Certificate and of the associated OIML type evaluation report(s) is not permitted, although either may be reproduced in full.

Descriptive annex

Description

Electromechanical price computing, single interval or multi-interval non-automatic weighing instruments, class III, intended for direct sales to public, with built-in displays (ACS-6E, ACS-15E, ACS-30E) or displays on pole (ACS-6EP, ACS-15EP, ACS-30EP) for vendor and customer.

Main parts

- Plastic housing containing the load cell (4-wire analogue load cell of type ZET-EC made of aluminium, incorporating strain gauges in a Wheatstone bridge configuration, rated capacities 10, 20 or 40 kg) and electronics
- Built-in displays (ACS-E) or vendor and customer display pole (ACS-EP)
- Membrane keyboard (24 keys)
- Leveling device (four feet) and level indicator (sensitivity at least 2 mm at limiting value of tilting 2/1000 in any direction)
- Stainless steel load receptor

EMC protection measures

- Metal cover (30 mm * 30 mm) on the PCB to protect the analog part, includes AD (YS1898), LDO(S1112B36), capacitors and resistors
- Ferrite around cable leading from PCB to display) (2 turns)
- Ferrite (clamp) around cable leading from PCB to keyboard)
- Ferrite for charge line (15 turns)
- Two ferrites (clamps) on load cell
- Ferrite on the load cell line (4 turns)

Technical and metrological data

Table 1: Technical and metrological data of measuring instrument

Type	ACS-6E	ACS-6EP	ACS-15E	ACS-15EP	ACS-30E	ACS-30EP
Max	6 kg	6 kg	6 / 15 kg	6 / 15 kg	15 / 30 kg	15 / 30 kg
Min	40 g	40 g	40 g	40 g	100 g	100 g
e	2 g	2 g	2 / 5 g	2 / 5 g	5 / 10g	5 / 10g
Accuracy class	III					
Tare-balancing range (Subtractive)	$\leq 1/3$ Max					
Special temperature limits	0 °C / +40 °C					
Power supply	AC 220 V (± 10 %) / 50 Hz, 110 V / 60 Hz, DC 4 V (optional battery rechargeable during operation of instrument)					
Software identification	embedded software, version EC-01 (displayed during start-up)					
Capacity of load cell	10 kg	10 kg	20 kg	20 kg	40 kg	40 kg

Interfaces and compatibility conditions

- RS-232 (1 x) - protective interface in the sense of 5.3.6.1 of OIML R76-1, used for weighing result output only.



Security measures

Weighing instrument is secured against unauthorized access (opening of cover allowing access to calibration pins, which are used for setting of parameters and adjustments) by two tamper evident seals placed on wire connecting screws connecting upper and lower part of weighing instrument with screws on lower part of weighing instrument.

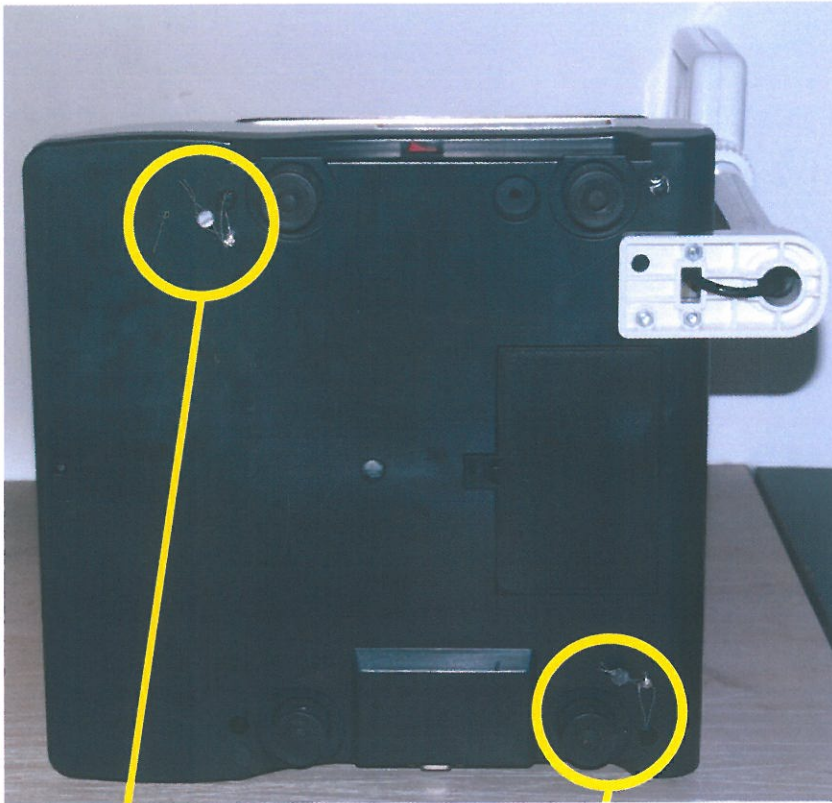

Fig. 1: Sealing of cover against opening

The data plate is located on the right side of the instrument, when viewed from the vendor side. It is secured, either by sealing or by being of a form such that it is destroyed when removed.

Other components that may not be dismantled or adjusted by the user shall be secured by a tamper-evident label bearing a securing mark.

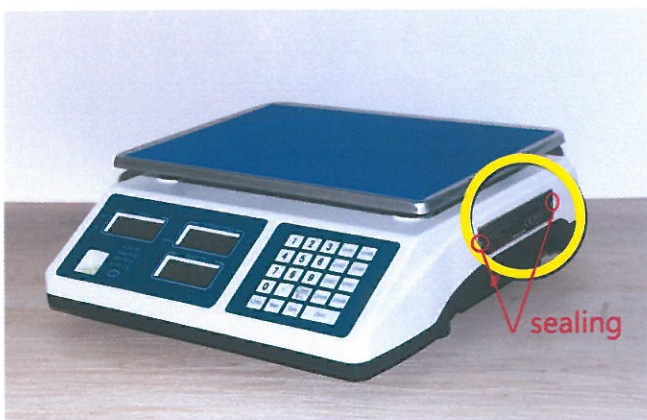

Fig. 2 - location of sealing marks on data plate



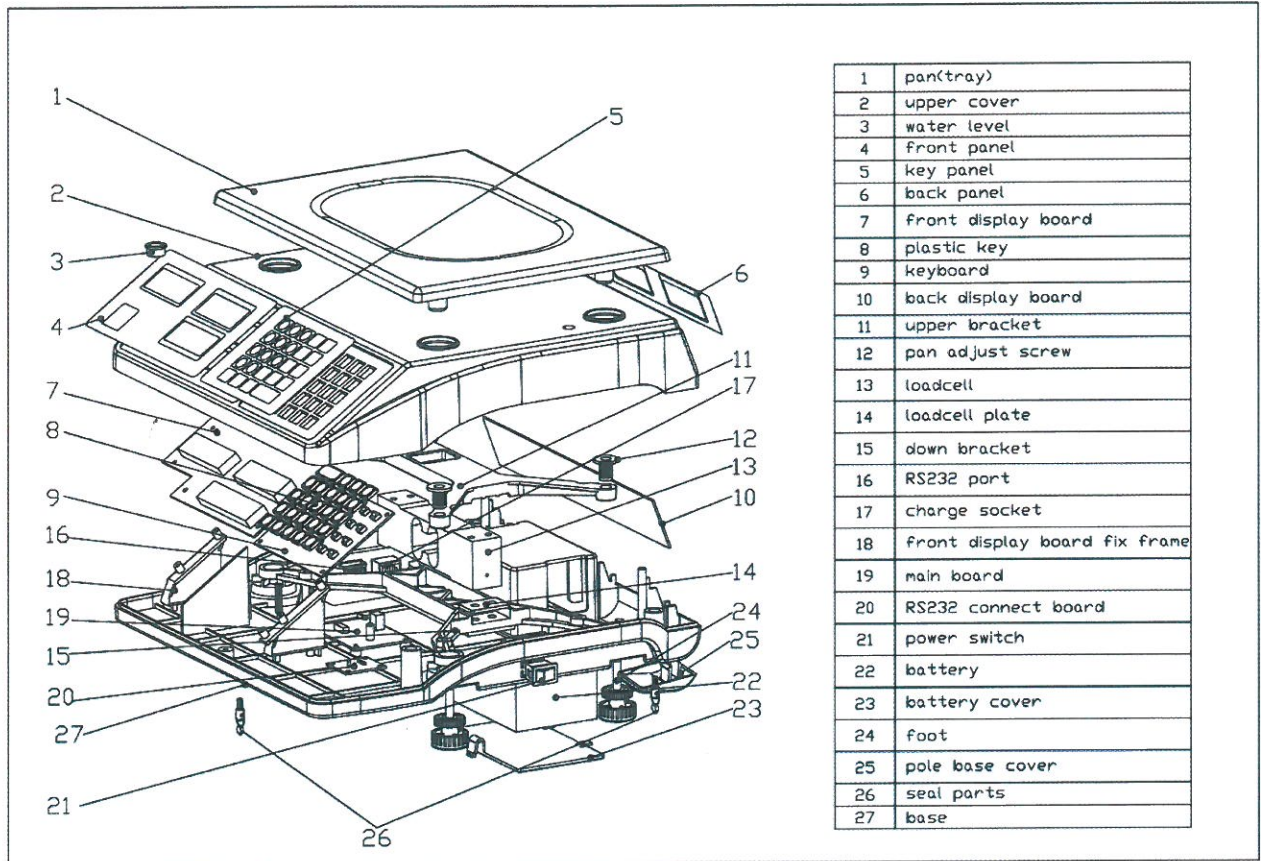

Fig. 3 - Exploded view of instrument (variants ACS-6E, ACS-15E, ACS-30E)



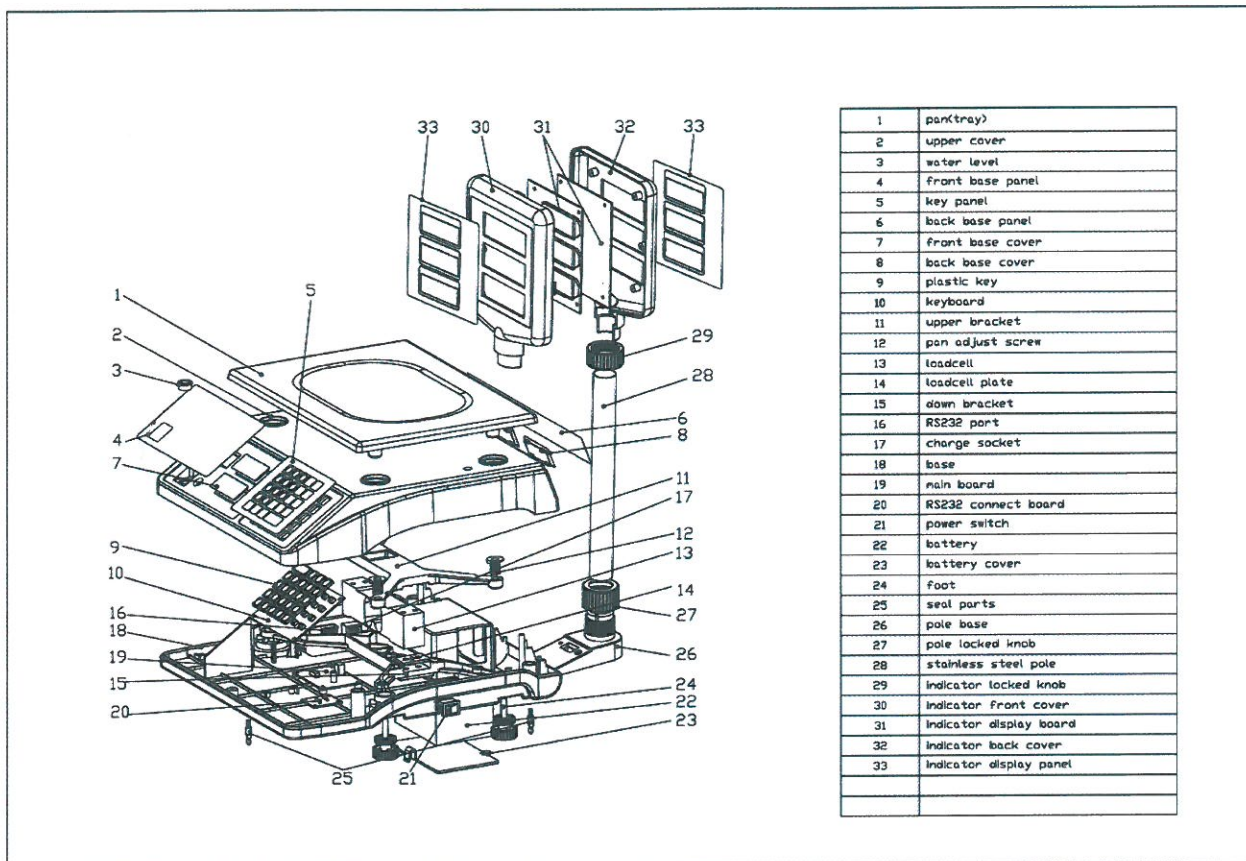

Fig. 4 - Exploded view of instrument (variants ACS-6EP, ACS-15EP, ACS-30EP)

